



PASPALEY PEARL - LIFE ONBOARD

SMALL FOOTPRINTS. INFINITE HORIZONS



KIMBERLEY . PAPUA NEW GUINEA . EAST INDONESIA . RAJA AMPAT . BORNEO



RAJA AMPAT



PAPUA NEW GUINEA



THE KIMBERLEY



BORNEO



PEARL EXPEDITIONS

SHARED ADVENTURES

Welcome to a different kind of exploration aboard a stylish expedition motor-yacht shared with just 30 fellow adventurers. With Pearl Expeditions, adventure and discovery converge as you explore extraordinary landscapes with your expedition team.

Our approach centres on meaningful connections – with pristine environments, local cultures, and fellow travellers – transforming individual moments into collective discoveries that become part of your shared story.



PASPALLEY PEARL

ADVANCED TECHNOLOGY MEETS ENVIRONMENTAL STEWARDSHIP

YOUR EXPEDITION VESSEL - PASPALEY PEARL



Paspaley Pearl represents boutique expedition vessel design at its finest, where her classification under 50 meters unlocks pristine destinations larger ships cannot reach. The ship is environmentally and technologically advanced to increase efficiency and reduce footprint. Two Azipod drives powered by three diesel generators deliver exceptional manoeuvrability, fuel efficiency, and whisper-quiet operation, while her purposeful proportions provide remarkable capability for accessing remote environments.

Advanced systems demonstrate our environmental commitment: catalytic inverters reduce NOX emissions by 90%, heat recovery transforms engine heat into hot water, and dynamic positioning system reduces the need to use anchors in sensitive marine

environments. State-of-the-art stabilisers ensure exceptional comfort while advanced wastewater treatment protects pristine waters.

Dual Starlink systems provide seamless connectivity, upgraded waste compactors minimise environmental impact. These are some of the features that ensure operational efficiency, supporting guest experience and environmental responsibility.

This is expedition technology designed for today's explorers—sophisticated, sustainable, and capable of accessing the inaccessible.

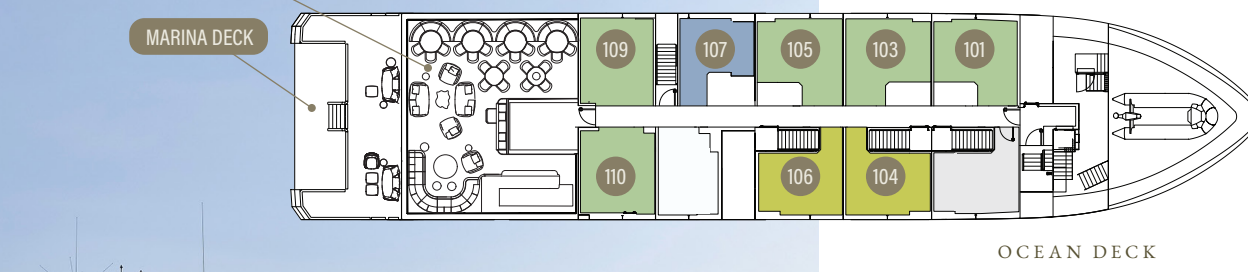
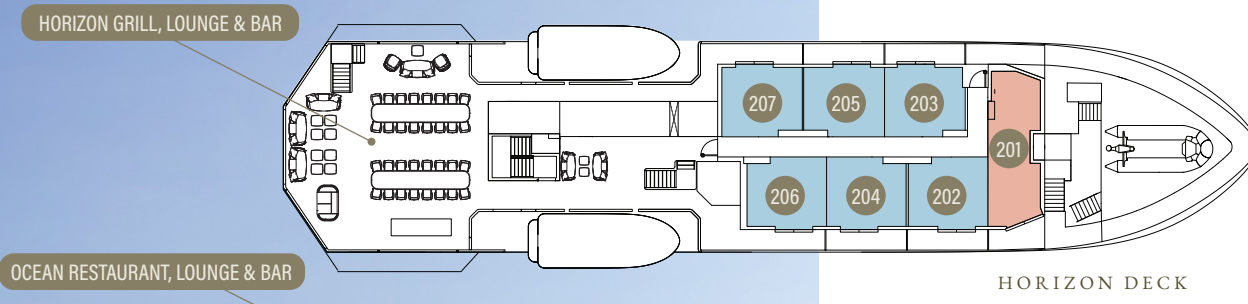
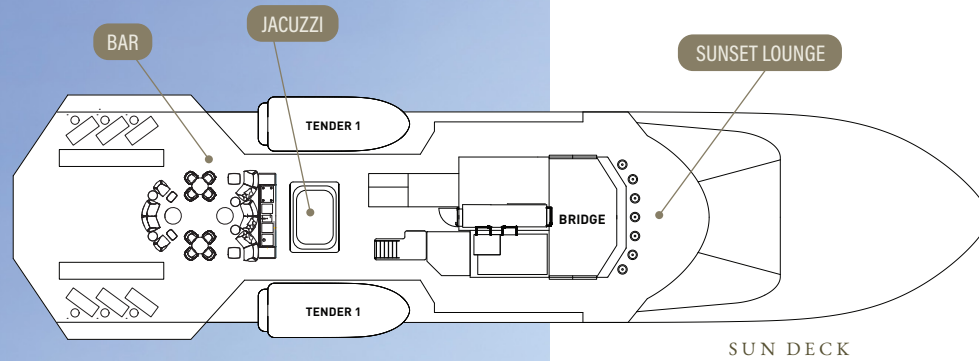
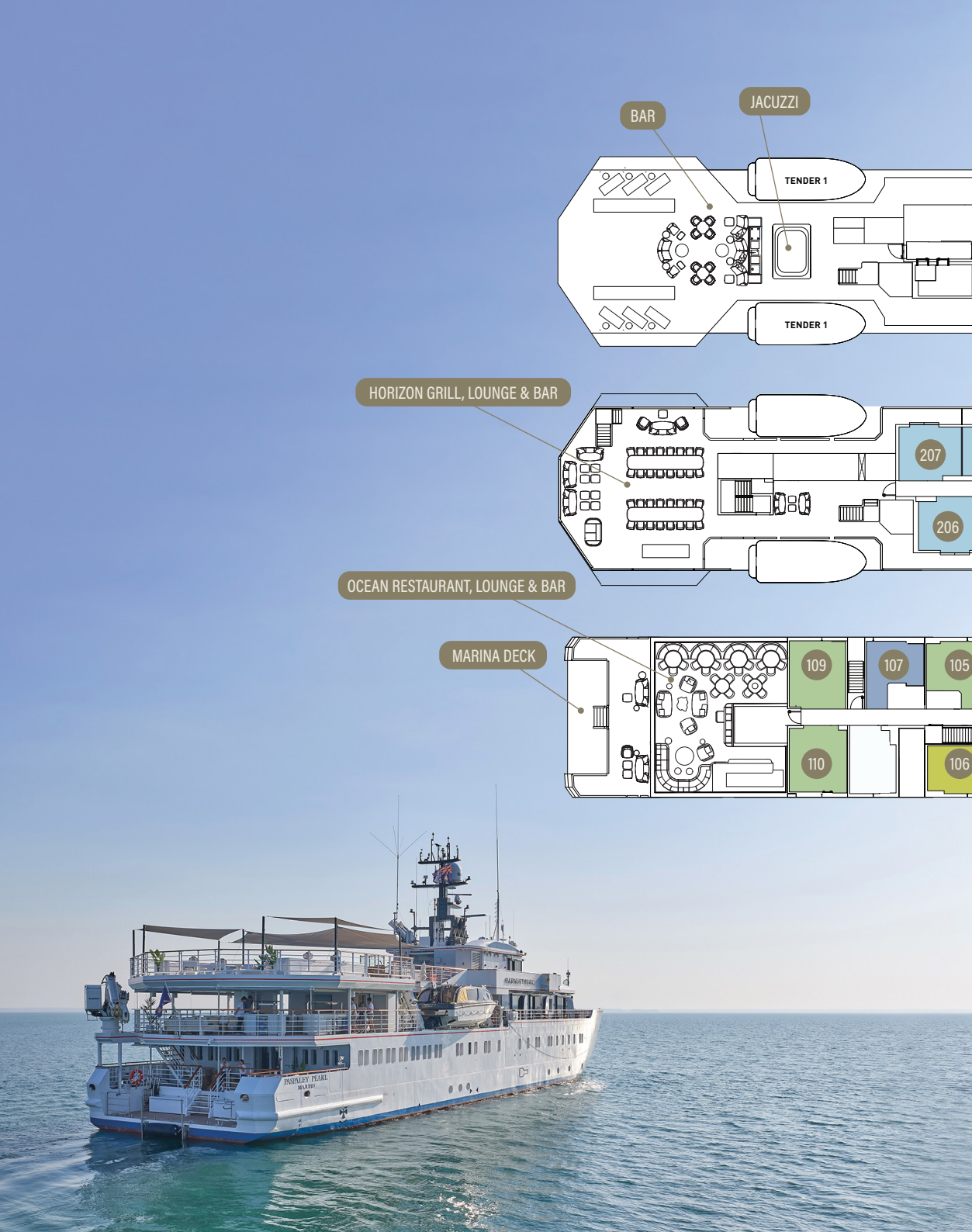

- Ocean Double Stateroom
14sqm / Double Bed
- Ocean Twin Stateroom
16sqm / Twin Bed
- Ocean Stateroom
17.5, 18sqm / Queen Bed
- Horizon Suite
20sqm inc. balcony / Queen Bed
- Pearl Suite
27sqm inc. balcony / Queen Bed

YOUR EXPEDITION VESSEL
**PASPALEY
PEARL**

Paspasley Pearl's extensive facilities and technical capabilities make her unique in the world of boutique, expedition yachts:

- Maximum 30 guest capacity
- 32 seat indoor Ocean Restaurant, Lounge and Bar
- 32 seat outdoor Horizon Grill restaurant
- Sun Deck lounge and bar, sunbeds, 8-10 person jacuzzi
- Sunset lounge forward of the bridge
- 15 staterooms or suites.
- 7 staterooms with private balcony – the only boutique yacht in the region with balconies
- Marina deck for embarkation of expedition boats and Zodiacs
- Swimming, kayaking, paddle boarding directly from the stern of the yacht



PASPALEY PEARL

ONBOARD LIVING

Life aboard *Paspaley Pearl* flows naturally between thoughtfully designed spaces that foster both intimate conversations and shared discoveries with your fellow adventurers.

The Ocean Restaurant's elegant 32-seat indoor setting creates perfect environments for leisurely dinners where stories of the day's encounters unfold over carefully crafted cuisine, while the adjacent lounge and bar invite nightcap conversations in relaxed comfort.

During the day, the Horizon's 32-seat outdoor restaurant and lounge becomes your social hub, where breakfast discussions spark anticipation for upcoming adventures and lunch gatherings celebrate morning discoveries.

As evening approaches, ascend to the Sun Deck's loungers and 8-10 person jacuzzi, where the day's tensions dissolve while sharing experiences with newfound friends against spectacular sunset backdrops.

Your nightly expedition recap unfolds in the outdoor lounge, where expedition team presentations featuring photo highlights become cherished rituals. Light-hearted banter flows as naturally as the premium wines, while tomorrow's possibilities are revealed beneath southern hemisphere constellations.

The intimate Sunset Lounge forward of the bridge offers quieter moments for reflection, where the gentle rhythm of the ocean and soft furnishings create a perfect sanctuary for processing the day's remarkable encounters in Earth's most pristine environments.





PASPALEY PEARL
OCEAN LOUNGE & DINING ROOM



PASPALEY PEARL
HORIZON DECK / SUN DECK



PASPALLEY PEARL ACCOMMODATION

While the experiences encountered ashore are paramount, so too is your comfort onboard. On *Paspaley Pearl*, adventure and elegance combine.

Each of the 15 Staterooms and Suites are designed to provide a relaxed ambiance for you to enjoy during your stay. Comfortable yet practical, with plenty of storage space, fine Aesop toiletries, soft furnishings and quality linen greet you.

The interior style reflects the history, destinations and communities we visit, a salute to the era of grand touring when

wicker was the signature furnishing, reminiscent of the days when travel was enjoyed only by the privileged few...

Our modern take reflects varied textual finishes – a gentle pallet of rattan, linen and copper add finishing touches that are warm and welcoming. Your relaxing haven after a day of activity.





HORIZON SUITE



PEARL SUITE



OCEAN STATEROOM



OCEAN TWIN STATEROOM

PASPALEY PEARL
ACCOMMODATION



ALEX BENTLEY

PASPALLEY PEARL

CULINARY EXCELLENCE

Over the past 20 years we have had a close association with Serge Dansereau of Bathers Pavilion, in Sydney. Serge has trained many chefs, and we are pleased to have Alex Bentley to be leading the culinary experience on Paspaley Pearl.

The guiding principles are fresh and regional, quality over quantity. You will see and spend time with Alex and his team of three throughout your voyage.

Our approach is leisurely and relaxed in the Horizon Grill and Lounge where we will offer daily breakfast and lunch. Vistas of the sea, and a catalogue of remarkable landscapes will greet you each morning, a perfect introduction to the day.

Each evening begins with our signature ritual in the Horizon Lounge and Bar, where expedition team recaps accompanied by drinks and canapés create leisurely reviews of the day's adventures, complete with photo highlights. Light-hearted banter amongst fellow adventurers enlivens these gatherings while our team reveals tomorrow's possibilities, building anticipation for yet another day of discovery.

À la carte dinner unfolds in our intimate Ocean Restaurant, where Alex and his culinary team craft daily-changing menus showcasing well-balanced three-course selections featuring local

and regional delicacies that tell the story of each destination. Modern Australian cuisine with Southeast Asian influences celebrates the cultures we explore, using carefully sourced, high-quality ingredients that transform each evening into a culinary experience.

Our extensive selection of Australian wines perfectly complements these dining experiences, with premium varietals chosen to enhance the flavours of each carefully crafted dish. Alternative and vegetarian choices ensure every palate is celebrated, while our commitment to quality over quantity means each meal becomes a memorable part of your expedition story, perfectly complementing your day's explorations in some of Earth's most remarkable destinations.



PASPALLEY PEARL

CULINARY EXCELLENCE





MONTGOMERY REEF - THE KIMBERLEY



PASPALLEY PEARL

PEARL EXPEDITIONS

A BESPOKE AUSTRALIAN EXPEDITION CRUISE EXPERIENCE

Pearl Expeditions—a new, proudly Australian, immersive expedition cruise venture. This initiative marks a partnership between Paspaley and cruise industry leader Sarina Bratton AM, bringing together unparalleled expertise and a shared passion for exploration.

This venture reunites Sarina Bratton with the Paspaley family who were co-founders of the acclaimed Orion Expedition Cruises – the pioneer of luxury expedition cruising in Australasia. Orion's legacy laid the foundation for what has since become a thriving global segment of the cruise industry.

Pearl Expeditions is a natural evolution of that groundbreaking vision. It draws on the deep regional knowledge of the Paspaley Group, combined with the talents of former Orion team members who first set the standard for boutique expedition travel.

Beyond their rich pearling heritage in the Kimberley, Paspaley also has extensive experience in luxury hospitality through its award-winning Wall Street Hotel in New York and is preparing to relaunch the Pinctada Hotel in Broome, Western Australia.



FOR FURTHER INFORMATION CONTACT:

Email: concierge@pearlexpeditions.com **Call:** +61 2 7235 9999 **Visit:** pearlexpeditions.com



PEARL
EXPEDITIONS

SMALL FOOTPRINTS. INFINITE HORIZONS